

Getting started with your new Sonim[®] Spot[™] H500 5G Mobile Hotspot

/01

Contents:

Sonim H500

Battery in Sonim H500

Wall charger

USB Type C cable

Quick Start Guide

SIM card

(Not included for all carriers)

© 2024 by Sonim Technologies, Inc.

1. External antenna connectors (TS-9)
2. Ethernet port (RJ45)
3. USB Type C
4. Status LED
5. Signal strength
6. Display
7. Connections info
8. Battery indicator
9. Menu
10. WiFi info
11. Power button
12. Battery under battery cover
13. SIM (SIM under battery)
14. Battery cover opening

/02



Applicable to 6 GHz devices only: Only use the device indoors. The operation of 6 GHz devices is prohibited on oil platforms, cars, trains, boats, and aircraft, except that operation of this device is permitted in large aircraft while flying above 10,000 feet. Operation of transmitters in the 5.925-7.125 GHz band is prohibited for control of or communications with unmanned aircraft systems.

/03

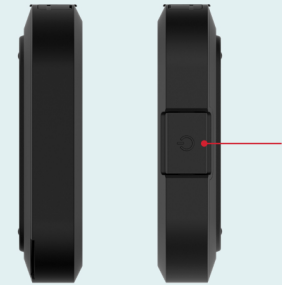

/04



/05

/06

How to insert a SIM

Check with your service provider if the SIM card is pre-installed already. If SIM card is not pre-installed, or the SIM card must be replaced:

Step 1

Remove the battery cover using the thumb catch on the back edge of the H500.



Step 2

Remove the battery.

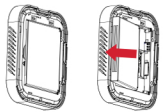

Step 3

Align the cutout tab using the diagram on H500 and gently slide the SIM card into the slot with the gold metal side down.



/07

How to insert the battery

Prior to first use, open the battery door and remove the plastic tab on the battery.

Step 1

Insert the battery flush into the cavity such that the three metallic contacts on the top of the battery are aligned with the metallic contacts within the battery compartment.



Step 2

Close the battery cover.

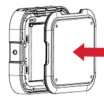

Note: The battery in your H500 is not fully charged. We recommend charging the device for 2 hours with the inbox wall charger and USB cable before use.

/08

Set up your H500

1. Press and hold the Power button for 3 seconds.
2. Open the WiFi application or controls on your laptop or WiFi-enabled device that you want to connect to your H500.
3. Find your H500's WiFi name (SSID). There are three WiFi names (SSID) in your H500, enter the password to connect any of the three SSIDs for the Internet access.

Note: the WiFi names (SSIDs) and password appear on the screen (under WiFi Info).

Device management

1. On your WiFi device or laptop that is connected to your H500, type <http://192.168.1.1> or <http://sonim.mobilehotspot/> in the browser bar.
2. Enter the **Username** and **Password**.
3. Click **Login**. You can modify the user credentials if you require.

Note: The default username is "admin" and the password is the same as the WiFi password (under WiFi Info on the screen)

/09

Changing the Username and Password

1. While connected to the H500, log into <http://192.168.1.1> or <http://sonim.mobilehotspot/> and select **Settings > Management Page**.
2. Select **System Admin**.
3. Enter the **Username** and **Password** that you want to change.
4. Select **Apply**. The screen displays the "Success" message.
5. Click **Logout**.

Warranty

Sonim Technologies provides a 1-Year warranty on your H500. Please register within 30 days of purchase at www.sonimtech.com/register to receive product information and updates. For more information related to the warranty, please contact your service provider.

Support

Web: sonimtech.com
Email: support@sonimtech.com
Phone: 1-833-697-6646
Monday – Friday: 24 hours a day
Saturday & Sunday: 9am-6pm ET

Download a User Guide:

from sonimtech.com or call 1-833-MY-SONIM (1-833-697-6646)

Sonim[®] Spot[™] H500 5G Mobile Hotspot Quick Start Guide



sonim.